

STARTERBATTERIEN | BATTERIES DE DÉMARRAGE

PREISLISTE | LISTE DE PRIX

6-2009

EXIDE[®]
BATTERIES



Preis- und Artikeländerungen vorbehalten.
Sous réserve de changements de prix et d'articles.

Artikel-Nr./No d'article
No d'articolo

Ausführung/Execution
Esecuzione

Kapazität / Capacitate
Capacità (Ah)

Kältestartstrom
Demarrage à froid
Corrente di spunto (A)

Preis exkl. MwSt. und vRB
Prix sans TVA et vRB
Prezzo senza IVA e CAR

Preis inkl. MwSt. und vRB
Prix avec TVA et CAR
Prezzo con IVA e CAR

Ersetzte Typen
Types remplacés
Tipi sostituiti

Länge / Longueur
Lunghezza (mm)

Breite / Largeur
Larghezza (mm)

Höhe / Hauteur
Altezza (mm)

Gewicht / Poids
Peso (kg)

Bodenbefestigung
Talon de fixation
Risaggio alla base

Polart / Bornes
Tipo di polo

Schaltung / Schéma

Bemerkungen / Remarques
Osservazioni

Exide AGM

AGM 760	L03	70	760	i.V.	i.V.	--	278	175	190	20.2	B13	1	0
AGM 900	L05	90	900	599.00	650.00	--	353	175	190	26.1	B13	1	0

Exide Premium

EA386	B19	38	300	161.00	178.75	535 20, B19L	187	127	220	10.4	Korean B1	1/3	0	1,2,3,4,6
EA387	B19	38	300	161.00	178.75	535 22, B19R	187	127	220	10.4	Korean B1	1/3	1	1,2,3,4,6
EA456	B24	45	390	201.00	221.75	545 23, 545 84, B24L	237	127	227	12.3	Korean B1	1/3	0	1,2,3,4,6
EA457	B24	45	390	201.00	221.75	545 24, 545 51, B24R	237	127	227	12.3	Korean B1	1/3	1	1,2,3,4,6
EA472	LB1	47	450	182.00	201.35	T4	207	175	175	12.6	B13	1	0	1,2,3,4,6
EA530	L01	53	540	216.00	237.90	H4	207	175	190	13.9	B13	1	0	1,2,3,4,6
EA602	LB2	60	600	208.00	229.30	T5	242	175	175	15.0	B13	1	0	1,2,3,4,6
EA640	L02	64	640	244.00	268.05	H5	242	175	190	16.3	B13	1	0	1,2,3,4,6
EA654	D23	65	580	219.00	241.15	560 68, D23L	230	173	222	16.7	Korean B1	1	0	1,2,3,4,6
EA655	D23	65	580	219.00	241.15	560 69, D23R	230	173	222	16.7	Korean B1	1	1	1,2,3,4,6
EA722	LB3	72	720	271.00	297.10	T6	278	175	175	17.3	B13	1	0	1,2,3,4,6
EA754	D26	75	630	273.00	299.25	570 29, D26L	270	173	222	18.5	Korean B1	1	0	1,2,3,4,6
EA755	D26	75	630	273.00	299.25	570 24, D26R	270	173	222	18.5	Korean B1	1	1	1,2,3,4,6
EA770	L03	77	760	283.00	310.00	H6	278	175	190	19.4	B13	1	0	1,2,3,4,6
EA852	LB4	85	800	308.00	336.90	T7	315	175	175	21.3	B13	1	0	1,2,3,4,6
EA1000	L05	100	900	335.00	365.95	H8	353	175	190	25.0	B13	1	0	1,2,3,4,6
EA1004	D31	100	850	375.00	409.00	600 32, D31L	306	173	222	24.1	Korean B1	1	0	1,2,3,4,6
EA1005	D31	100	850	375.00	409.00	600 33, D31R	306	173	222	24.1	Korean B1	1	1	1,2,3,4,6

Exide Excell

EB356	B19	35	240	144.00	160.45	535 20, B19L	187	127	220	9.5	B00	3	0	
EB357	B19	35	240	144.00	160.45	535 22, B19R	187	127	220	9.5	B00	3	1	
EB440	L00	44	400	161.00	178.75	540 10, H3	175	175	190	11.1	B13	1	0	1,2,3,4
EB442	LB1	44	420	158.00	175.50	536 46, 543 20, T4	207	175	175	12.0	B13/B14	1	0	1,2,3,4,5
EB443	LB1	44	420	181.00	200.25	543 17, T4	207	175	175	12.0	B13	19F	0	1,2,3,4,5
EB450	E02	45	330	171.00	189.50	545 77, E2	220	135	225	12.2	B01	1	0	1
EB451	E02	45	330	171.00	189.50	545 79, E2R	220	135	225	12.2	B01	1	1	1
EB454	B24	45	300	192.00	212.10	545 23	237	127	227	12.4	B00	1	0	
EB455	B24	45	300	192.00	212.10	545 24	237	127	227	12.4	B00	1	1	
EB456	B24	45	300	183.00	202.40	545 84, B24L	237	127	227	12.4	B00	3	0	
EB457	B24	45	300	183.00	202.40	545 51, B24R	237	127	227	12.4	B00	3	1	
EB500	L01	50	450	184.00	203.50	544 59, H4	207	175	190	13.0	B13	1	0	1,2,3,4,5
EB501	L01	50	450	171.00	189.50	544 64, H4R	207	175	190	13.0	B13	1	1	1,2,3,4,5
EB504	D20	50	360	182.00	201.35	550 41	200	173	222	13.0	Korean B1	1	0	1
EB505	D20	50	360	182.00	201.35	550 42	200	173	222	13.0	B00	1	1	1
EB542	LB2	54	520	189.00	208.85	545 19, 550 46, T5	242	175	175	14.3	B13/B14	1	0	1,2,3,4,5
EB543	LB2	54	520	211.00	232.55	554 27, T5	242	175	175	14.5	B13	19F	0	1,2,3,4,5
EB604	D23	60	390	199.00	219.60	560 68, D23L	230	173	222	15.5	B00	1	0	1,2
EB605	D23	60	390	199.00	219.60	560 69, D23R	230	173	222	15.5	B00	1	1	1,2
EB608	G75	60	640	254.00	278.80	560 26	230	180	186	15.2	B09	SAE	1	
EB620	L02	62	540	208.00	229.30	555 59, 562 19, H5	242	175	190	15.4	B13	1	0	1,2,3,4,5
EB621	L02	62	540	208.00	229.30	555 65, H5R	242	175	190	15.4	B13	1	1	1,2,3,4,5
EB704	D26	70	540	239.00	262.65	570 29, D26L	270	173	222	18.1	B09	1	0	1,2
EB705	D26	70	540	239.00	262.65	570 24, D26R	270	173	222	18.1	B09	1	1	1,2
EB712	LB3	71	670	235.00	258.35	564 20, 565 30, 571 13, T6	278	175	175	17.4	B13/B14	1	0	1,2,3,4,5
EB740	L03	74	680	241.00	264.80	566 38, 574 12, H6	278	175	190	18.0	B13	1	0	1,2,3,4,5
EB741	L03	74	680	242.00	265.90	572 19, H6R	278	175	190	18.0	B13	1	1	1,2,3,4,5
EB800	L04	80	700	266.00	291.70	580 35	315	175	190	20.4	B13	1	0	1,2,3,4,5
EB802	LB4	80	700	262.00	287.40	575 39, T7	315	175	175	20.3	B13	1	0	1,3,4,5
EB852	LB5	85	760	269.00	294.95	585 15, T8	353	175	175	21.0	B13	1	0	1,2,3,4,5
EB950	L05	95	800	285.00	312.15	588 27, 600 38, H8	353	175	190	23.5	B13	1	0	1,2,3,4,5
EB1004	D31	100	720	319.00	348.75	600 32, D31L	306	173	222	23.5	Korean B1	1	0	1,2
EB1005	D31	100	720	319.00	348.75	600 33, D31R	306	173	222	23.5	Korean B1	1	1	1,2

Artikel-Nr./No d'article
No d'articolo

Ausführung/Exécution
Esecuzione

Kapazität / Capacitate
Capacità (Ah)

Kaltstartstrom
Demarrage à froid
Corrente di spunto (A)

Preis inkl. MwSt. und vRB
Prix sans TVA et vRB
Prezzo senza IVA e CAR

Preis inkl. MwSt. und vRB
Prix avec TVA et CAR
Prezzo con IVA e CAR

Ersetzte Typen
Types remplacés
Tipi sostituiti

Länge / Longueur
Lunghezza (mm)

Breite / Largeur
Larghezza (mm)

Höhe / Hauteur
Altezza (mm)

Gewicht / Poids
Peso (kg)

Bodenbefestigung
Talon de fixation
Risseggio alla base

Polart / Bornes
Tipo di polo

Schaltung / Schéma

Bemerkungen / Remarques
Osservazioni

Exide Classic

EC412	LB1	41	370	158.00	175.50	536 53, 543 20	207	175	175	11.5	B13	1	0
EC440	L01	44	360	184.00	203.50	544 59	207	175	190	12.0	B13	1	0
EC502	LB2	50	510	189.00	208.85	545 19, 550 46	242	175	175	14.2	B13/B14	1	0
EC550	L02	55	460	208.00	229.30	555 59	242	175	190	14.3	B13	1	0
EC652	LB3	65	540	235.00	258.35	563 18, 565 30	278	175	175	16.5	B13/B14	1	0
EC700	L03	70	640	241.00	264.80	566 38, 570 12	278	175	190	17.7	B13	1	0
EC900	L05	90	720	285.00	312.15	588 27	353	175	190	22.8	B13	1	0

Exide Maxxima

Max 900	G34	50	800	512.00	556.40	12 Volt	260	173	206	17.0	--		0,1
Max 900 DC	G34	50	750	547.00	594.05	12 Volt	260	173	206	18.0	--		1

Exide Classic Oldtimer

084 11	6 V	84	390	363.00	396.10	6 Volt	277	170	221	11.5	B13	1	0
--------	-----	----	-----	--------	--------	--------	-----	-----	-----	------	-----	---	---

Exide Truck

680 32	SHD	180	1000	616.00	668.30	67028 / 67043 68034	513	223	223	27.7	B	1	3
725 12	SHD	225	1150	752.00	814.65	72018 / 71014	518	279	240	34.6	C	1	3
600 99	HD	100	680	367.00	400.40	60026 / 60027 / 60525	413	175	220	29.9	D01	1	0
605 98	HD	110	750	354.00	386.40	59041 / 59616 / 60527	345	175	239	29.9	D02	1	1
605 99	HD	110	750	354.00	386.40	59040 / 59615 / 60528	345	175	239	37.0	D02	1	0
610 99	HD	110	760	394.00	429.45	61026 / 61040 / 61043	512	175	210	36.5	M110D	1	3
620 99	HD	120	680	409.00	445.60	61017 / 61034 / 62034	513	189	223	38.9	A	1	3
625 23	HD	125		550.00	597.30	-	286	269	230	42.4	D07	1	2
625 99	HD	125	760	417.00	454.20	62512 / 62511 / 62529	349	175	290	48.2	D03	1	0
635 99	HD	135	1000	469.00	510.15	63539 / 63543	512	175	210	29.9	M110D	1	3
640 99	HD	140	800	447.00	486.45	63530 / 64020	513	189	223	29.9	D4/A	1	3
643 99	HD	143	950	491.00	533.80	64322 / 64323 / 64329	512	218	210	37.0	M140D	1	3
650 99	HD	150	900	473.00	514.45	63511 / 64317 / 64327	513	223	223	36.5	D5/B	1	3
680 99	HD	180	1000	519.00	563.95	66514 / 67018 / 68022	513	223	223	38.9	D5/B	1	3
700 038	HD	210	1200	655.00	710.30	70027	518	279	240	42.4	D6/C	1	3

Exide Multicraft

918 01	6 V	240	--	534.00	580.10	240 15, 914 51	244	190	275	32.0	B00	1	0
956 02	L03	80	--	312.00	341.20	575 40, 580 24, 956 01	278	175	190	20.7	B13	1	0
958 03	L05	95	--	397.00	432.65	957 51, 958 01	353	175	190	25.0	B13	1	0
960 51		140	--	507.00	551.05	640 23, 961 51	513	189	223	37.6	B00	1	3
963 51	D05	175	--	677.00	733.95	680 25, 963 02	513	223	223	46.8	B00	1	3
968 01	D06	230	--	851.00	921.15	730 11	518	286	242	61.0	B00	1	3

Exide Gel

G 16	12 V	16	--	206.00	227.15	--	181	76	167	5.9	--	5	0
G 19	12 V	19	--	281.00	307.85	--	186	82	174	7.3	--	5	0
G 25	12 V	24	--	199.00	219.60	--	176	167	126	9.7	--	5	0
G 30	12 V	30	--	201.00	221.75	--	197	132	180	11.7	--	5	1
G 40	12 V	36	--	302.00	330.45	--	210	175	175	14.8	B04	5	0
G 60	12 V	60	--	383.00	417.60	956 02, 566 35, 574 12	278	175	190	21.2	B03	1	0
G 80	12 V	80	--	490.00	532.75	958 03, 588 38, 588 27	353	175	190	26.8	B03	1	0
G 85	12 V	85	--	522.00	567.15	--	330	171	236	31.6	--	1	1
G 110	12 V	110	--	859.00	929.80	625 23	286	269	230	40.0	--	1	2
G 120	12 V	120	--	755.00	817.90	961 51, 635 45	513	189	223	40.7	--	1	3
G 120S	12 V	120	--	795.00	860.90	--	345	175	290	40.5	--	1	0
G 140	12 V	143	--	865.00	936.25	963 51, 680 32	513	223	225	47.8	--	1	3
G 210	12 V	210	--	1098.00	1186.95	968 01, 680 21, 700 27	518	276	242	70.0	--	1	3
G 180/6	12 V	180	--	643.00	697.35	--	244	190	275	30.0	--	1	1

Bemerkungen

Remarques

Osservazioni

- 1 Griff
- 2 Ladekontrollanzeige
- 3 Rückzündschutz
- 4 Zentralentgasung
- 5 Manifolddeckel
- 6 Doppeldeckelsystem

- 1 Poignée
- 2 Indicateur d'état de charge
- 3 Pastille anti-déflagrante
- 4 Dispositif de dégazage central
- 5 Couvercle de type "Manifold"
- 6 Système de couvercle double

Bodenleiste

Talons

Base

B0

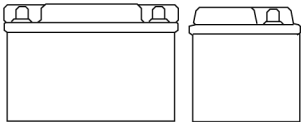

Korean B1

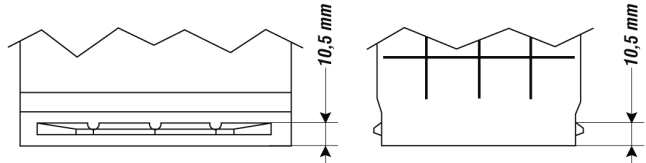

B1

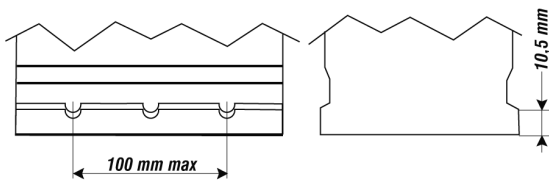

B13

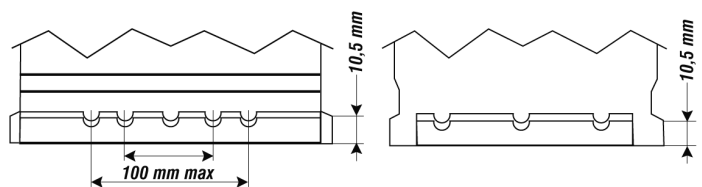

B9

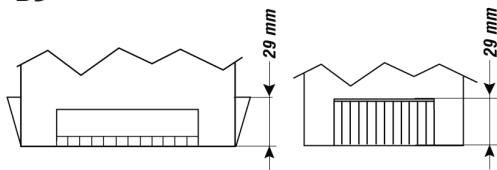

B14

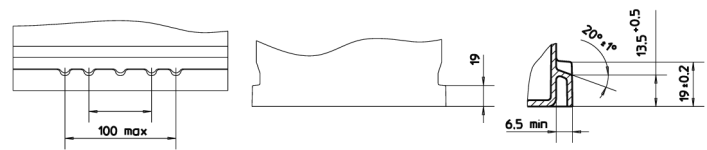

Polarten

Types de bornes

Tipi di polo

1 (EN)

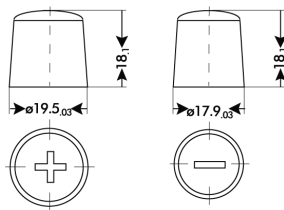

21 (SAE S)

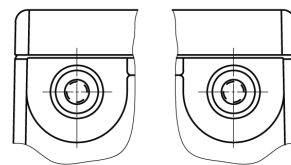

3 (JIS)

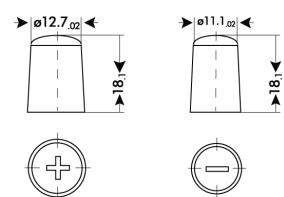

19 (Ford)

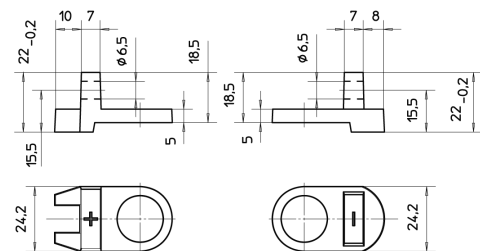

Schaltungen

Schémas des pôles

Schema di polo

0

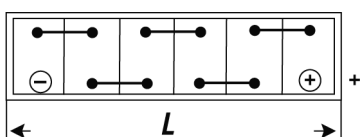

1

